

## simalube IMPULSE quick instruction guide for installation, removal, refill and disposal

### Define installation type and accessories



Direct Installation

Indirect Installation

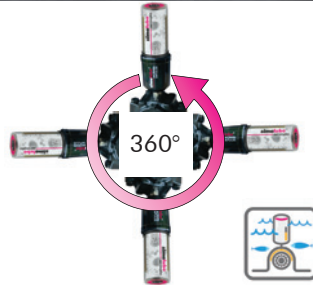

simalube lubricators and simalube IMPULSE can be installed in all positions, even underwater.



Use „Calculation Pro“ to choose correct dispensing time and lubricator size.

(„Calculation Pro“ is available at [www.simalube.be](http://www.simalube.be), in the App Store, and in the Android Market.)



### Prepare lubrication point



Clean lubrication point

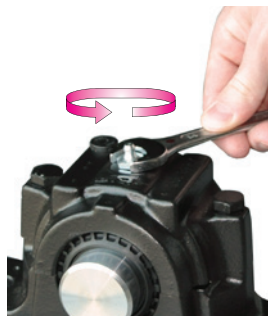

Remove connector nipple



Screw in reducing nipple and seal lubrication point

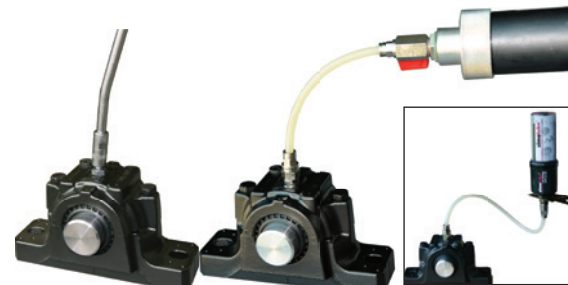

Lubricate the grease lines with a grease gun (fill tubes completely)

### Install and activate simalube and IMPULSE



Screw the IMPULSE onto lubrication point

⚠ IMPULSE logo must face the front



Cut off plug



Activate dispensing time with 3 mm Allen key



Write in activation date



Insert the battery pack



Screw the lubricator onto the IMPULSE



Device will be activated, green LED will blink 2x

⚠ The first pump cycle will begin within 30 seconds



Check simalube and IMPULSE regularly

## Replace the lubricator



Replace or refill the empty lubricator



Check and clean the gasket  
**!** IMPULSE remains on lubrication point



Remove the used battery pack and replace it with a new one



Screw refilled or new lubricator onto the lubrication point

### Period of use of the simalube IMPULSE:

10x simalube dispensing cycles

or

3 years from the production date



## Correct disposal of the simalube and IMPULSE



Dispose empty lubricator

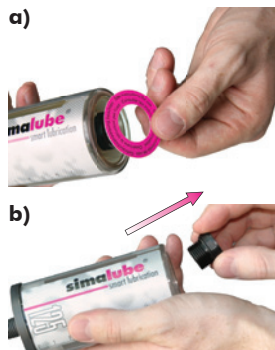

a) Remove cover disk  
 b) Remove gas generator with a socket wrench (SW21 mm)



Dispose of intact gas generator in battery recycling and empty housing in plastic recycling.  
 (Warning: dispose of leftover grease separately)



Dispose simalube IMPULSE



Dispose of used battery pack in battery recycling and IMPULSE device in accordance with Directive 2002/96/EG (WEEE).