

### SCHRITT 1

Vorbereitung der Schmierstelle

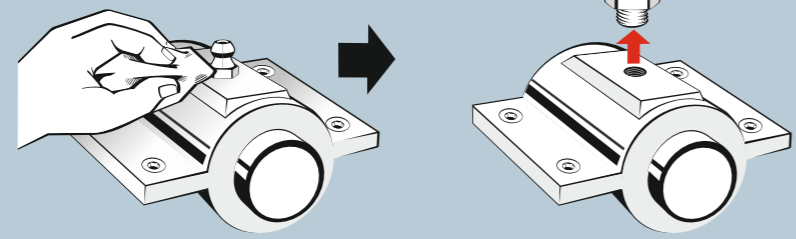

Bauteile gründlich reinigen!

### SCHRITT 2

Zwischenelemente

Zwischenelemente wie Anschlusssteile, Schläuche oder Verschraubungen müssen vorbefüllt werden.

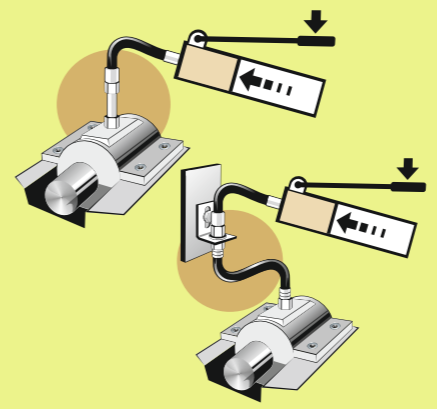

Gleichen Schmierstoff wie im Schmierstoffgeber verwenden!

### SCHRITT 3

Befüllung

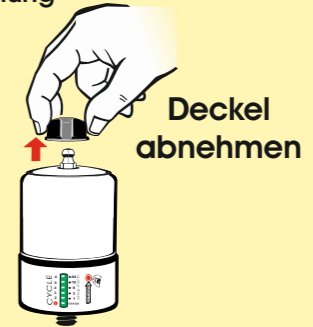

Deckel abnehmen

Bis "MAX" mit Schmierstoff füllen

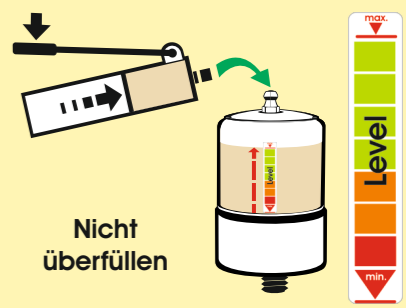

Nicht überfüllen

### SCHRITT 4

Inbetriebnahme

Die Magnetkappe ist der Schlüssel zur Bedienung der BEKAONE.

1. Magnetkappe abnehmen

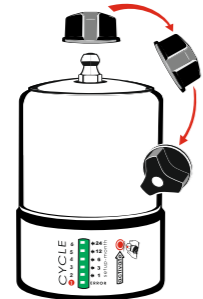

2. zum Activate Feld führen...

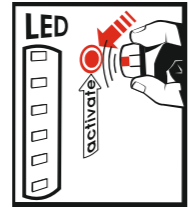

3. und auf dem Activate Feld platzieren

Die rote LED blinkt 5x

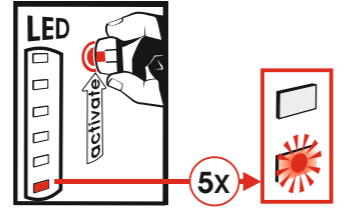

4. Magnetkappe entfernen und ca. 1-2 sec warten

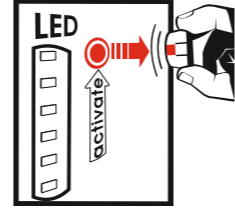

5. zurück zum Activate Feld führen

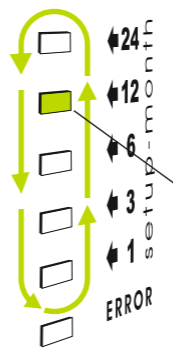
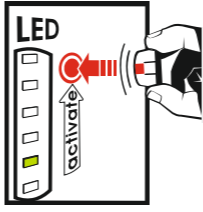

6. die grüne LED durchläuft die LED-Leiste

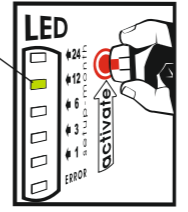

7.

Die Magnetkappe entfernen, wenn die gewünschte Einstellung erreicht ist.

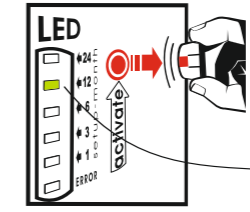

Beispiel: 12 Monate

8.

Falls ein Fehler aufgetreten ist, oder die gewählten Einstellungen zurückgesetzt werden sollen:

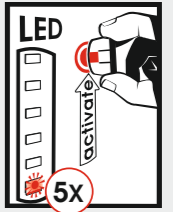

- Magnetkappe auf dem Activate Feld platzieren.
- Rote LED leuchtet 5x. Pumpe schaltet ab. Rote LED bestätigt.
- Pumpe einschalten.

### SCHRITT 5

Sonderschmierung

Eine Sonderschmierung wird benötigt:

- beim Befüllen einer leeren BEKAONE
- bei einer Zwischenschmierung

Sonderschmierung aktivieren

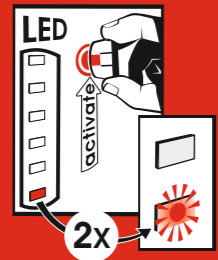

Rote LED blinkt 2x  
Pumpe beginnt zu fördern.

Wie in der Abbildung

- Magnetkappe auf Activate Feld platzieren
- 2x blinken lassen
- Magnetkappe entfernen
- Pumpe läuft an (ca. 7sec)
- dann ca. 4sec. Pause
- Pumpe läuft an (ca. 7sec)

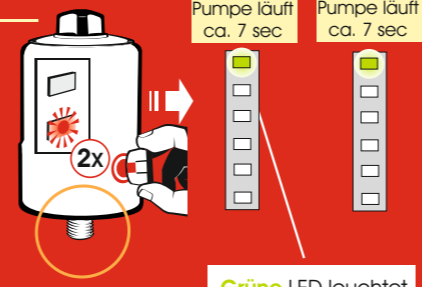

Pumpe läuft ca. 7 sec

Pumpe läuft ca. 7 sec

Grüne LED leuchtet entsprechend der gewählten Monateinstellung

Dieser Vorgang sollte 5x durchgeführt werden, bis der Schmierstoff ohne Luftblasen austritt.

Schmierstoff muss ohne Luftblasen austreten!

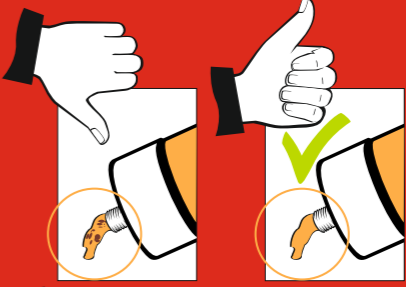

falsch

richtig

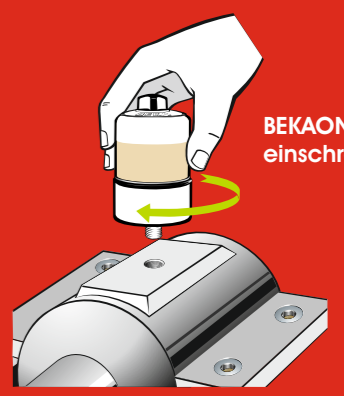

BEKAONE einschrauben

## STEP 1

Preparing the lubricating point

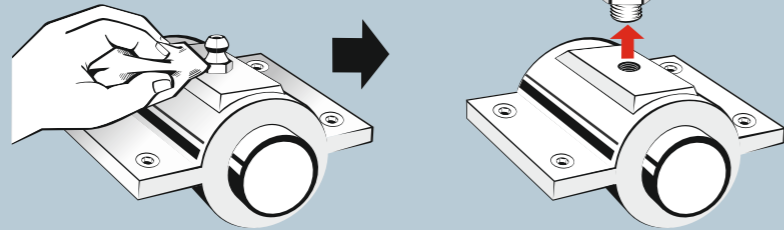

Clean components thoroughly!

## STEP 2

Connecting elements

Connecting elements like hoses or fittings have to be prefilled.

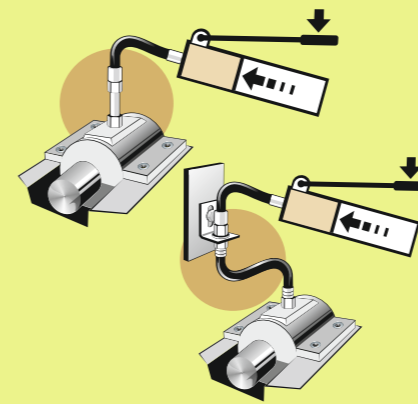

Use the same lubricant!  
as in the lubricator!

## STEP 3

Filling



Remove cover

Fill up to "MAX" with lubricant

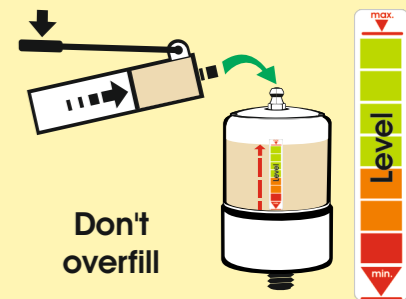

Don't overfill



## STEP 4

Start up



The magnet cap is the key to make settings of BEKAONE.

### 1.

Remove magnet cap

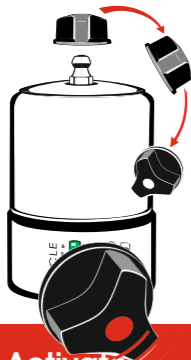

### 2.

go to Activate Zone

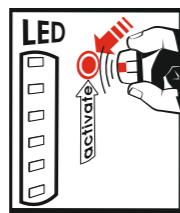

### 3.

and place it on Activate Zone

Red LED flashes 5x

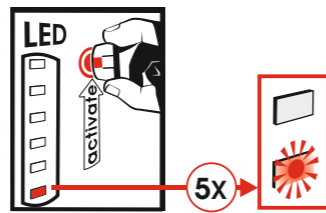

### 4.

Remove magnet cap and wait approx. 1 - 2 sec

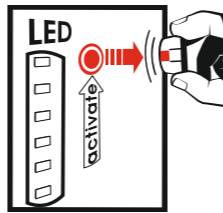

### 5.

Go back to Activate Zone

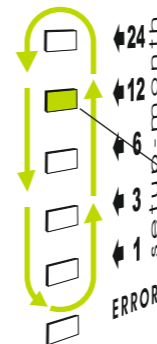
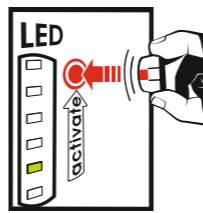

### 6.

Green LED runs through LED strip

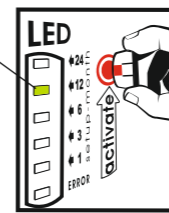

### 7.

Remove magnet cap as soon as requested setting is reached

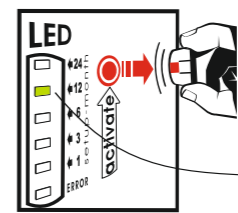

Example: 12 months

### 8.

In case of error or if the settings should be changed:

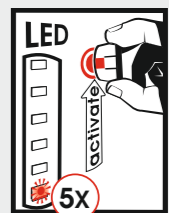

- Place magnet cap on Activate Zone
- Red LED flashes 5 times. Pump is switched off. Red LED confirms
- Switch on pump.

## STEP 5

Additional lubrication

An additional lubrication is necessary:  
- for filling an empty BEKAONE  
- for an intermediate lubrication

Activate Additional lubrication

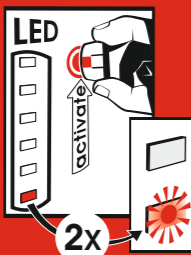

Red LED flashes 2 times

Pump starts delivering

As shown in picture

- Place magnet cap on Activate Zone
- LED flashes 2x
- Remove magnet cap
- Pump starts running (approx. 7sec)
- Approx. 4sec. break
- Pump starts running (approx. 7sec)

This procedure should be carried out 5 times until lubricant comes out without air bubbles.

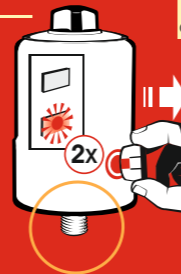

Pump works approx. 7 sec

Pump works approx. 7 sec

Green LED lights corresponding to month setting



Lubricant has to come out without air bubbles



not OK



OK

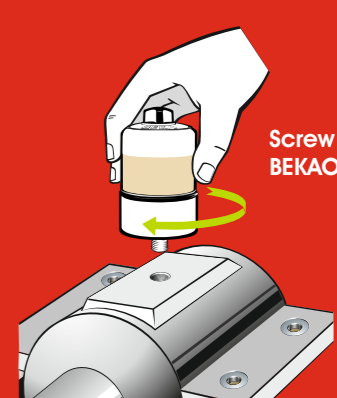

Screw in BEKAONE